

TE 2225X

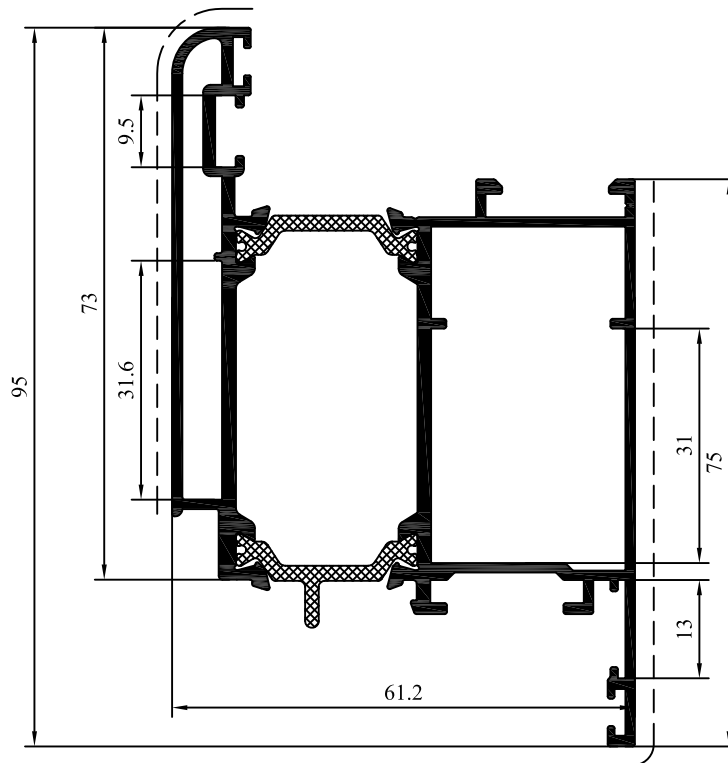

Perfil		P. Teórico	Área Trata. / Pol.	Momentos de Inércia
TE-2225		1.73	0.48 / 0.16	$I_x = - / I_y = -$
TE-2211/C		0.79	0.22 / 0.08	$I_x = - / I_y = -$
TE-2211/A		0.94	0.30 / 0.08	$I_x = 4.8 / I_y = 15.5$
Acessórios:		ES.AP.T2531C.BC ES.AP.T531.DB	ES.AL.EACOR60.BC ES.AL.N3.CC	

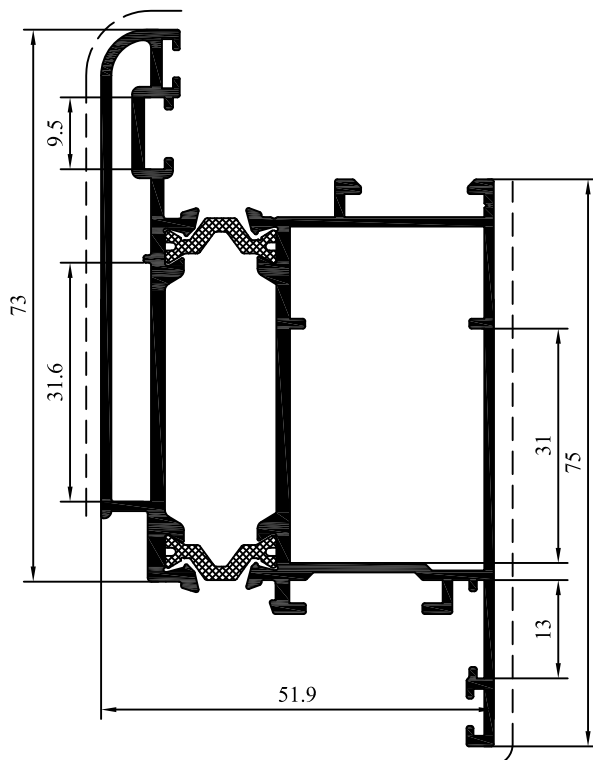



TE 2225

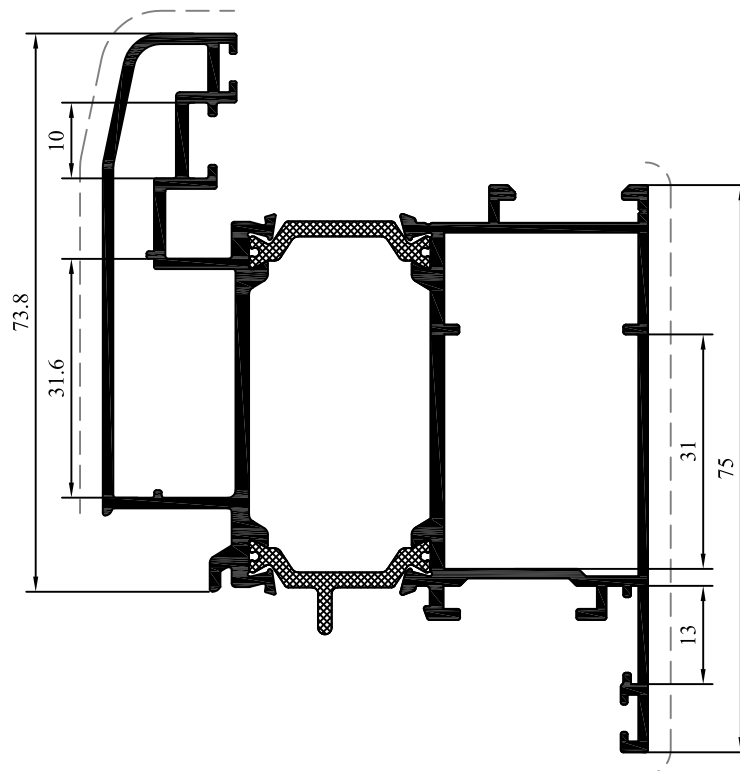

Perfil		P. Teórico	Área Trata. / Pol.	Momentos de Inércia
TE-2225		1.73	0.48 / 0.16	$I_x = - / I_y = -$
TE-2211/C		0.79	0.22 / 0.08	$I_x = - / I_y = -$
TE-2211/A		0.94	0.30 / 0.08	$I_x = - / I_y = -$
Acessórios:		ES.AP.T2531C.BC ES.AP.T531.DB	ES.AL.EACOR60.BC ES.AL.N3.CC	

TE 2611



Perfil		P. Teórico	Área Trata. / Pol.
TE-2611		1.90	0.53 / 0.16
TE-2611/B		0.97	0.27 / 0.08
TE-2211/A		0.93	0.30 / 0.08
Acessórios:			

— — - Área Polimento